

Medtronic

Engineering the extraordinary

What's new

MiniMed™ 780G system with Guardian™ 4 sensor



What's the same



Sensor Insertion sites

Ages 7 - 17 years

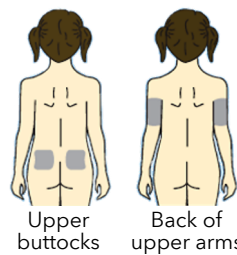

Insertion on abdomen for ages 7-17 years has not been evaluated for accuracy.

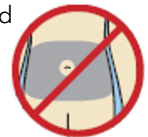

Ages 18 and older

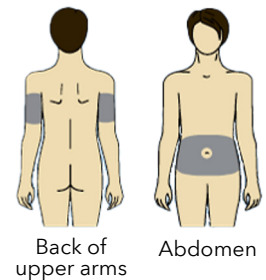

Insertion on upper buttocks for ages 18+ years has not been evaluated for accuracy.



What's new

Component highlights



Guardian™ 4 Transmitter

Guardian™ 4 Sensor¹

- Shell without imprint
- Sensor warm up (2 hours)
- 2.8-22.2 mmol/L operating range
- No calibration needed² - however, every blood glucose (BG) reading is needed when entering SmartGuard™ feature. If glucose alerts and CGM readings do not match your symptoms, use a BG meter to calibrate the sensor

1. Chemistry is the same as Guardian™ sensor 3. Manufacturing and quality control measures are optimized. Sensor works up to 7 days. Average sensor life ~ 6 days
 2. A blood glucose (BG) reading is needed when entering SmartGuard™ feature. If glucose alerts and CGM readings do not match your symptoms, use a BG meter to make treatment decisions.

"Sensor Updating" message may occur on the pump screen when the algorithm indicates the sensor is not working properly. Most sensors resume normal function, so there is no need to take action unless recommended by the system. In the event that the updating lasts for more than 3 hours, the recommendation is to replace the sensor to maximize time in the SmartGuard™ feature.

Sensor start

The Guardian™ 4 transmitter skips the sensor warm-up alert when warm-up starts.

When 2 hour warm-up ends, the pump begins receiving sensor glucose (SG) readings - no alert occurs.

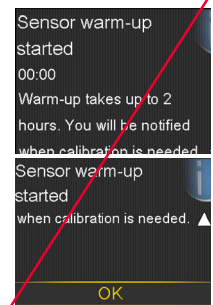

Sensor status icon

This icon only appears when the sensor feature is on.

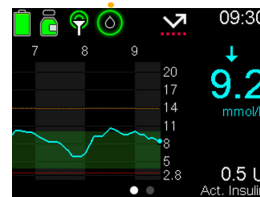

Icons

- When the sensor is **working** and no action is required for the sensor, the icon has a solid green circle around it.
- When the icon turns red, a **BG reading is required**.
- If sensor **information is unavailable**, the icon has a solid blue circle around a question mark.
- This occurs when the **pump is waiting** for the sensor status to update, including warm-up and calibration.

Making treatment decisions in manual mode

Sensor glucose information can help make treatment decisions, but decisions should be made on all information:

- Trend arrows
- Most recent sensor glucose (SG) reading
- Sensor trend graph
- Active alerts
- Active insulin
- Recent activities such as medication, exercise
- Glucose target ranges

In Manual mode, use the Bolus Wizard™ feature to calculate a bolus using a blood glucose (BG) reading. Adjust the bolus amount based on the rising or falling SG value.

NOTE: It is not recommended to deliver boluses too close together. Consult your healthcare professional (HCP) for dosing information.

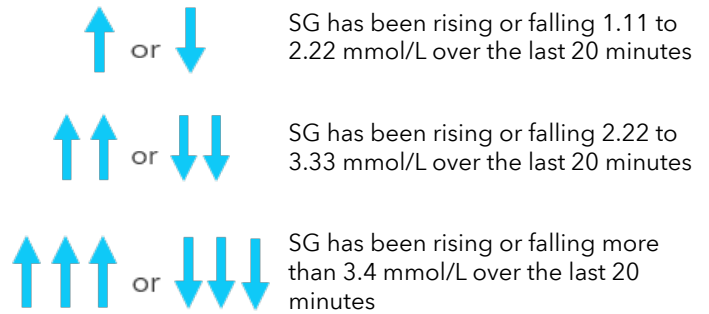

When to use a blood glucose value

No fingersticks* are needed for calibration nor to make treatment decisions. However, you will check your BG on a BG meter instead of using SG readings to make treatment decisions in the following cases:

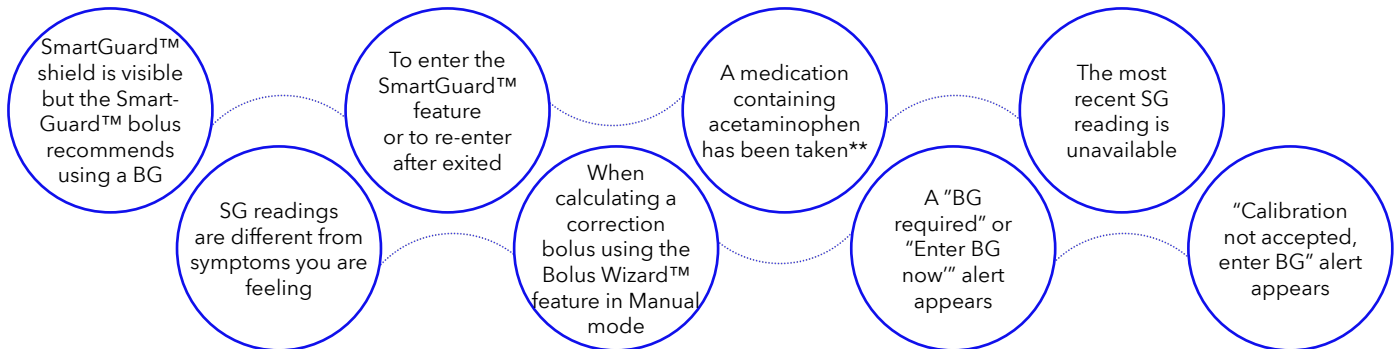

Every BG reading provided to the pump is used to calibrate the sensor. If a calibration is not accepted, the system will ask for an additional BG. *A BG is needed when you first enter SmartGuard™ feature. If glucose alerts and CGM readings do not match your symptoms, use a blood glucose meter to make treatment decisions. Refer to System User Guide - SmartGuard™ feature. Some user interaction required. **Please refer to your healthcare professional for further guidance regarding use of these medications.

Start using your Guardian™ 4 Transmitter

Unpair Current Transmitter

Select Paired Devices

Select Sensor

Select Unpair

Select Yes to confirm

When you unpair a transmitter from the pump, you will immediately exit SmartGuard™ feature and enter manual mode

Pair Charged Guardian™ 4 Transmitter

Select Pair New Device

Search

Select Device

Confirm Device

Now that you've paired the Guardian™ 4 transmitter with the pump, you're ready to insert a Guardian™ 4 sensor. Remember, after you complete the 2-hour warm-up and SG is available on the pump, the system will ask for a BG to re-enter the SmartGuard™ feature.

See the device manual for detailed information regarding the instructions for use, indications, contraindications, warnings, precautions, and potential adverse events. For further information, contact your local Medtronic representative.
 © 2024 Medtronic. All rights reserved. Medtronic, Medtronic logo and Engineering the extraordinary are trademarks of Medtronic.
 †Third party brands are trademarks of their respective owners. All other brands are trademarks of a Medtronic company. ACCU-CHEK, ACCU-CHEK GUIDE, ACCU-CHEK FASTCLIX, and ACCU-CHEK SOFTCLIX are trademarks of Roche Diabetes Care. CA-DIB-0081-E